

LUNA INTERIOR BLIND

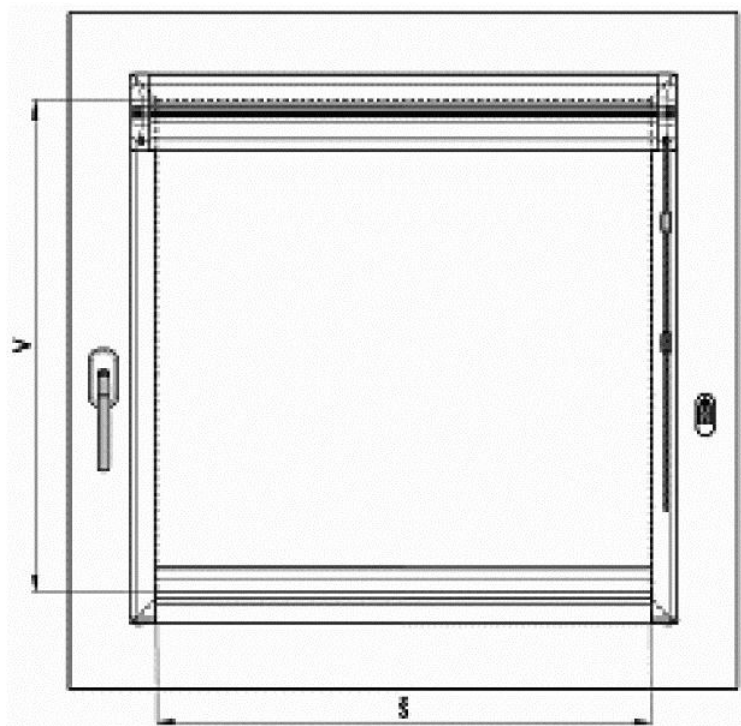

1. INSTALLATION IN WINDOW WINGS:

ORDERING DIMENSIONS (DIMENSIONS OF FINISHED ROLLER BLIND):

roller blind width X

= width from left top of glazing bar to right top of glazing bar, at the attachment point of the roller blind. In the case of windows with a square glazing bar the roller blind width is equal to the width of the glass pane, including the rubber or silicone seal. In case of offset or otherwise shaped glazing bars the measurement should be consulted.

roller blind height Y

= the height from the top of the glazing bar to the bottom of the glazing bar.

Note: in the case of the offset LUNA roller blind the total dimensions of the roller blind is specified including the top section, side plates with covers.

Note:

In order to be able to open the window to 90°, the minimum distance between the window wing frame and window lining must be 40 mm.

Note: For installation of the Luna roller blind the minimum depth of the glazing bar is 14 mm.

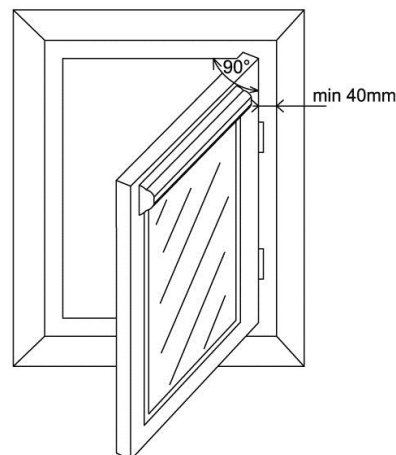

TOOLS FOR INSTALLATION:

- tape measure
- drill, drill bits
- bits PZ1, PZ2
- pencil, cutter, scissors
- degreasing agent (soapy water, technical benzene, etc.)

	Installation of side plate R+L	Attachment of top section	Attachment of chain mechanism
screw	3 x 12	3 x 20	3,9 x 16
drill Ø	2 mm	-----	3 mm

INSTALLATION:

- remove the side covers of the roller blind RRn 02/1 and RRn 01 (left control), by pulling towards yourself.
- place the roller blind onto the window wing and check that it fits the window width. Check that the blind control elements are on the correct side, we recommend marking the position of the screws, using the openings in both side plates, onto the glazing bar of the window wing; take care that the roller blind is horizontal!
- we recommend you check the quantity and type of supplied screws and pre-drill four holes for attaching the roller blind using a thin drill bit,
- using the supplied screws attach the roller blind to the glazing bars on the left side and also on the right side. In case of offset or otherwise shaped glazing bars it is necessary to place distance washers under the roller blind and guide bars (not included in delivery),
- take extra care when selecting the screw length for various glazing bar depths (the standard supplied screw is 3 x 12 mm). The screw could come into contact with the vacuumed double-glazing and damage it.
- if screws cannot be used to attach the roller blind, attach double-sided adhesive tape along the entire length of the top section RR 07, as well as on the bottom surfaces of both side plates, and attach the roller blind to the window which must be thoroughly cleaned and degreased.
- place the side covers back onto the roller blind,
- installation of guide bars:
- Check the correct length of the guide bars, remove the protective layer from the double-sided adhesive tape and attach the guide bars to a thoroughly cleaned and degreased glazing bar according to the diagram below. In case of an offset roller blind you must use U-shaped guide bars instead of the flat guide bars. Installation is identical.

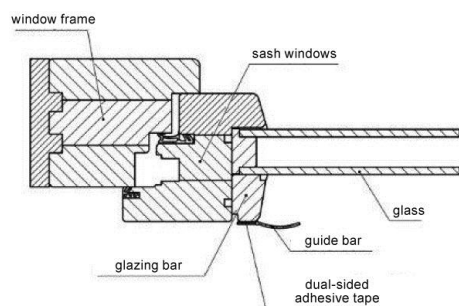

- setting bottom stop:

Drop the blind to the bottom position and attach the chain coupling IS 28 to the chain so that it touches the top side cover and close the coupling with an audible click. Screw tight the chain arrester.

ATTENTION!

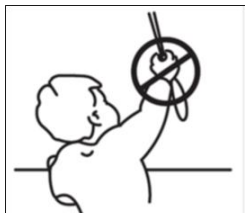

Pursuant to the EN 13120:2014 standard, window blinds shall be installed in accordance with the following instructions:

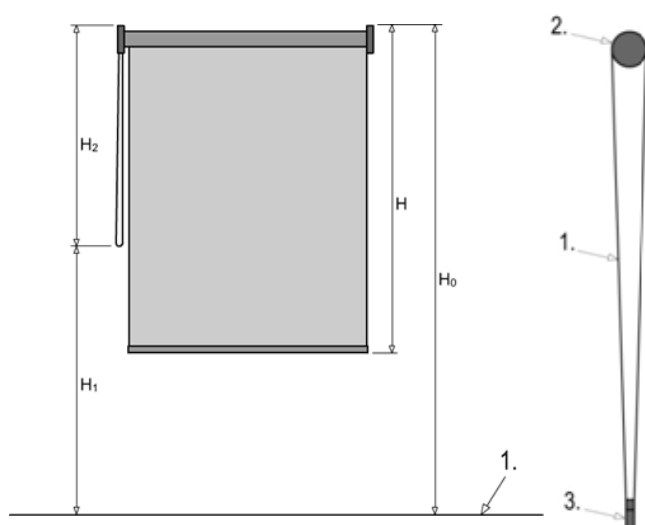

Chain:

If a breakaway coupler is used:

The chain length must be limited as follows:

- 1) If installation height (H0) is not specified, the chain length (H2) shall be less than or equal to 2/3 of the blind height (see Fig. 1): $H_2 \leq 2/3 H$.
- 2) If installation height (H0) is specified, the distance from the floor to the bottom part of the pull cord (H1) shall be at least 0.6 m: $H_1 > 0.6 \text{ m}$.

A dangerous loop must be eliminated when a mass of 6 kg is applied or within 5 seconds of application.

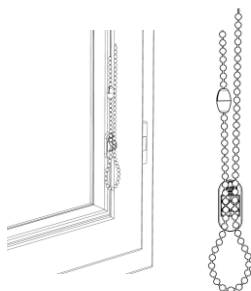

APPLY ONE HALF OF THE COUPLER TO EACH END OF THE CHAIN AND THEN LOCK BOTH COUPLER HALVES.

ILLUSTRATION OF INSTALLATION:

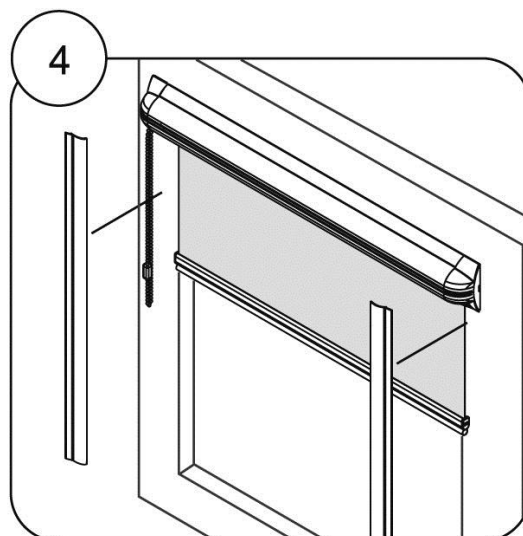
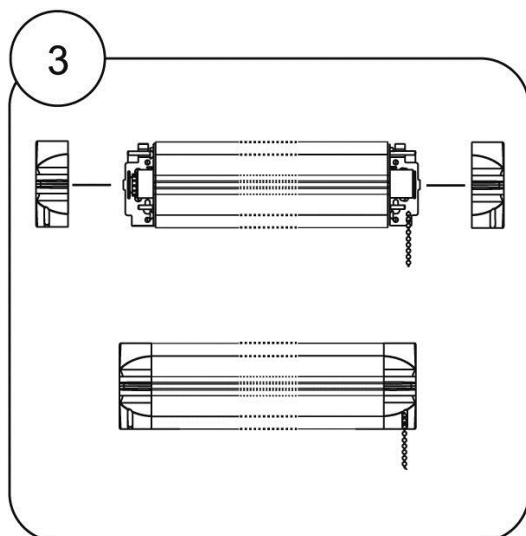
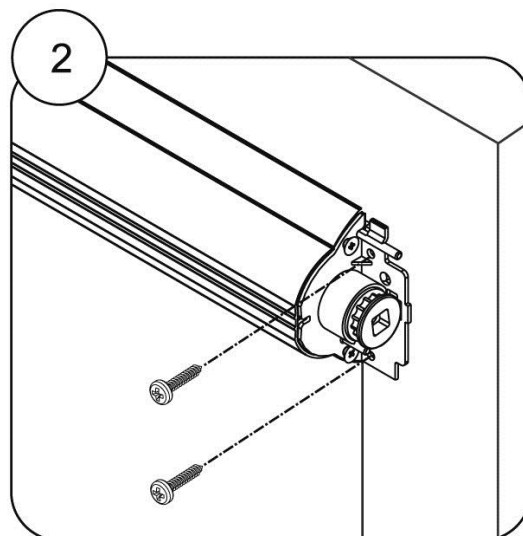
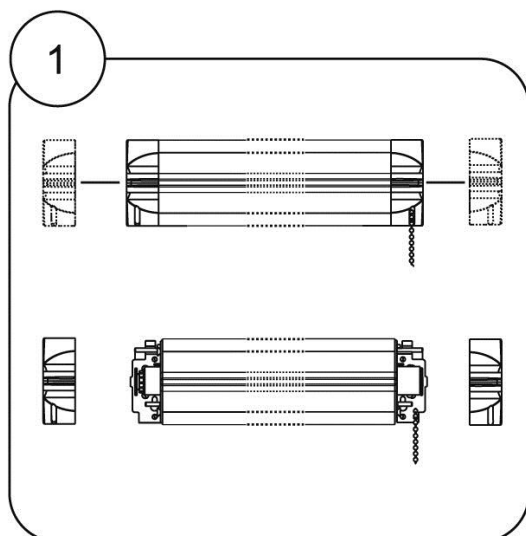

Illustration of installation:

